



KL1000 - 2017 Installation Instructions

Views: 126



Special Notes

Please read carefully:

- Before installing the lock, load the batteries and familiarise yourself with the operation and programming.
- The handle will not turn until you enter the factory default Master Code 11335577 or the User Code 2244.
- Please see programming guide to set your own codes.
- Your KitLock is supplied ready to fit to doors up to 19mm ($\frac{3}{4}$ ") thick. For doors between 19mm ($\frac{3}{4}$ ") and 25mm (1") thick, you will need to install the 28.5mm (1 $\frac{1}{8}$ ") spare spindle (see below). A 9mm ($\frac{3}{8}$ ") spindle is also included for sheet metal doors (see below).

1. Remove the lower 2 fixing screws.
2. Remove cover plate, spindle and threaded shaft.
3. Replace with spare spindle and threaded shaft.
4. Replace cover plate.

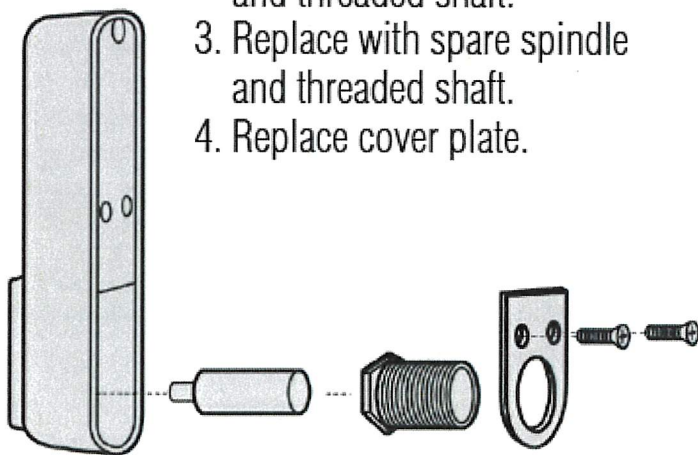

The KitLock can be fitted to:

A Cabinets, cupboards and lockers etc as a direct replacement for existing cam locks.

B It can also be fitted easily to cupboards and cabinets that do not have an existing locking device.

- 1 KitLock
- 2 Upper fixing bolts x 2
- 3 Packer pieces x 3
- 4 Locking nut
- 5 Cams x 2
- 6 Cam fixing nut and locking washer

Batteries – 2 x 1.5V AAA

Template x 1

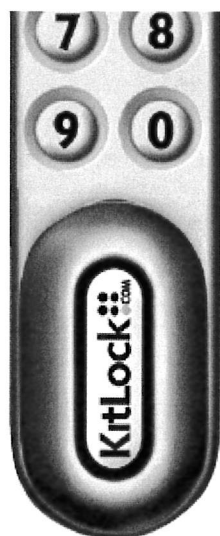
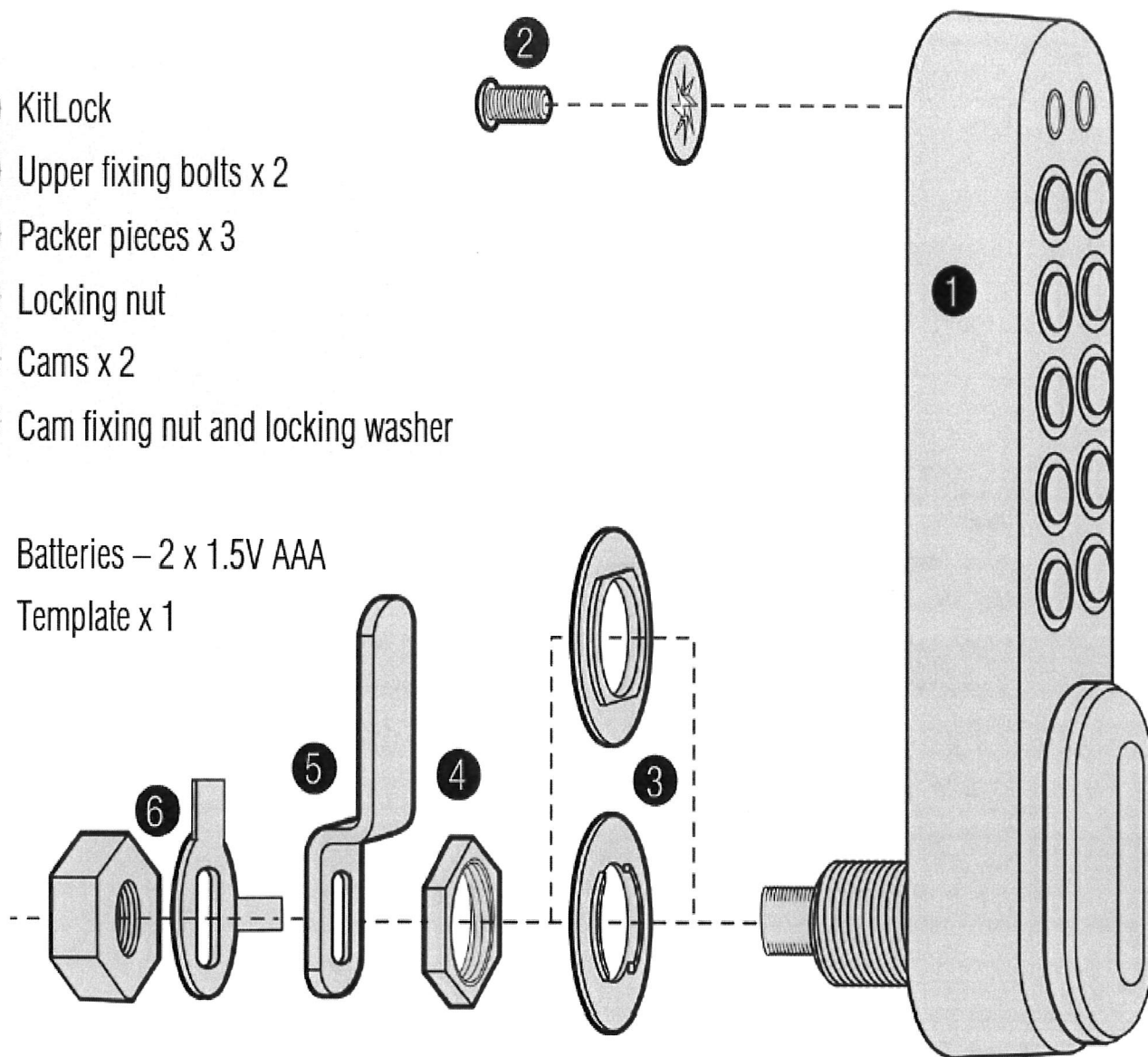

LOCKED

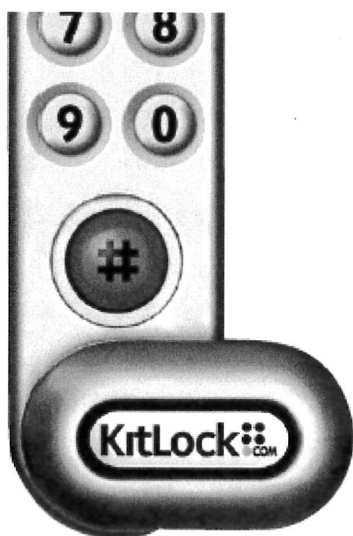

OPEN

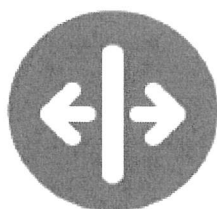
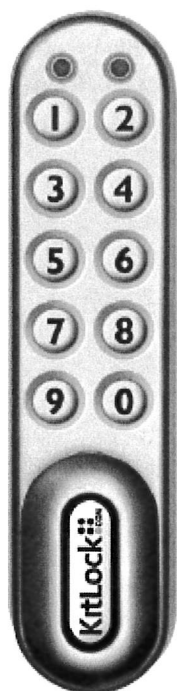

KL1000 can be supplied vertically, left or right hand horizontal.

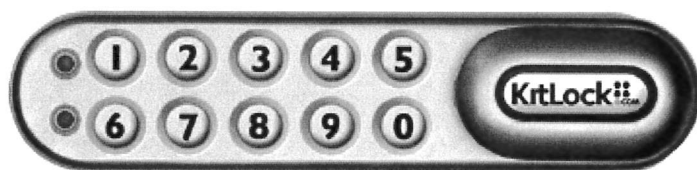
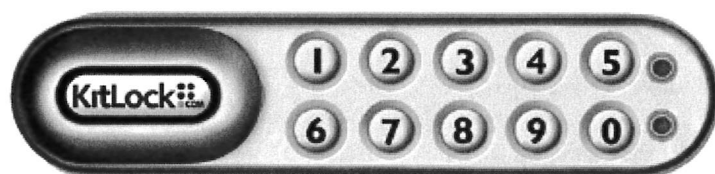

Installation Guide

A Replace existing cam lock with KitLock

Step 1 Remove existing cam lock.

Step 2 Place the 16mm ($\frac{5}{8}$ ") template hole over the hole left by the cam lock and mark the upper fixing hole.

Step 3 Drill the 6mm ($\frac{1}{4}$ ") upper fixing hole.

Step 4 Fit the KitLock to the door by passing the spindle through the 16mm ($\frac{5}{8}$ ") hole.

Step 5 If required, from the inside of the door, pass either of the packing pieces over the spindle to centralise the lock.

Step 6 Now secure the lock by threading the large nut onto the spindle.

Step 7 Fit one of the upper fixing bolts to suit your door thickness.

Step 8 Select and fit cam using the fixing nut and locking washer. Lock nut in place by folding over washer tabs.

Step 9 Now check the operation of the lock using the factory User Code 2244.

Step 10 If the lock is functioning correctly, CHANGE THE DEFAULT MASTER CODE 11335577 and DEFAULT USER CODE 2244 and program the lock using the programming and operating instructions enclosed.

B New Installation

Step 1 Place template on door and mark upper 6mm ($\frac{1}{4}$ ") hole and lower 16mm ($\frac{5}{8}$ ") hole.

IMPORTANT NOTE: Before drilling fixing holes, please ensure the position of the KitLock when fitted will allow enough clearance for selected cam to work.

Step 2 Drill both fixing holes.

Step 3 Continue installation from step 4 to 10, above.

II-KL1000-v7:1017

© 2018 Codelocks Ltd. All rights reserved.

Keywords: Lock Locks Kit Kitlock Kitlocker Locker Program Programming Instruction Instruct Help Support Troubleshoot Troubleshooting Sequence Sequences Install Installation Parameters Settings Setting KL 1000 NC 2017 current