

Electronic Lock

User Manual - S35B



Special Attention:

- This lock has a mechanical key override from the outside. Please ensure keys are kept in a safe place in case of complete battery failure. This key can be used to access the door from the outside.
- Please replace the battery when low battery alarm activates.
- Please read this instruction manual fully before installing.

1. Introduction

1.1. Lock Structure

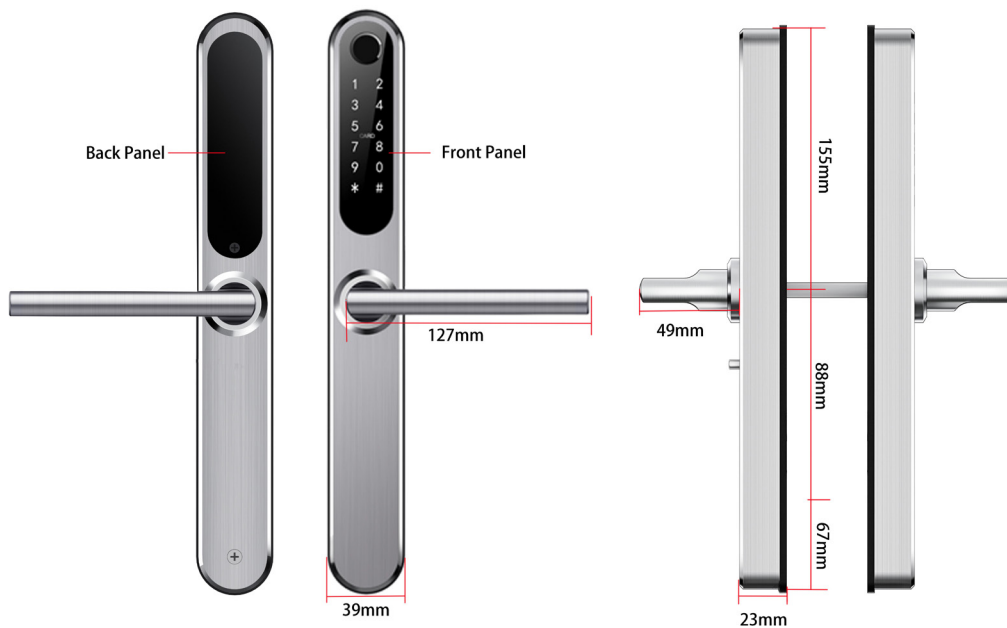

1.1. Packing List

NO	NAME	QTY	NO	NAME	QTY
1	Outside Lever	1	10	Screw Threaded Posts: 35*8mm	2
2	Inside Lever	1	11	T Screws: 16x5mm	2
3	Mortice SI35	1	12	Mortice Screws: 10*5mm (for aluminum doors)	4
4	Card	2	13	Mortice Screws: 25*4mm (for wooden doors)	1
5	Mechanical Key	2	14	M5*30mm Screw for Door Thickness 30-65mm	1
6	Waterproof Rubber Seal	2	15	M5*50mm Screw for Door Thickness 50-65mm	1
7	Split Pin	1	16	M5*70mm Screw for Door Thickness 50-65mm	1
8	User Manual	1	17	Square Spindle for Door Thickness 35-55mm	1
9	Strike & Strike Box	1+1	18	Square Spindle for Door Thickness 45-65mm	1

1.3.Specifications

Suitable for models	SL35E	Doors Applicable	Aluminum Door Wooden Door
Materials	Handle: SS304 Panel: SS304	Working Voltage	35-65mm
Lock Weight	3KG	Door Thickness	35-65mm
Unlocking Way	Bluetooth Fingerprint(option) Password Card Mechanical key Gateway(option)	Data Capacity	Fingerprint: 200 Password: 150 Card: 150
Color	Silver Black	Working Temperature	-100C - 550C
Low Wattage Alarm	Less than 4.8v	Working Humidity	0-95%

SYSTEM INITIALISATION

Open the cover plate of the front panel, long press and hold the “Reset” button on the back panel for 5s, press “000#”, and the initialisation is complete

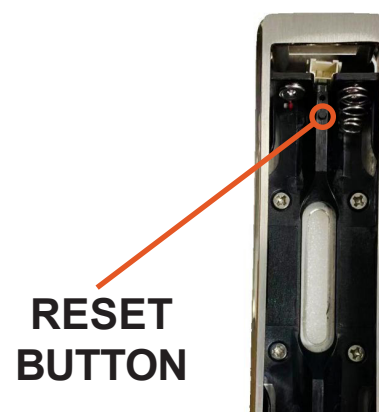

2. Installation

2.1. Turn the Handle

Notice: Adjust the handle according to the direction you open the door.

Outside handle:

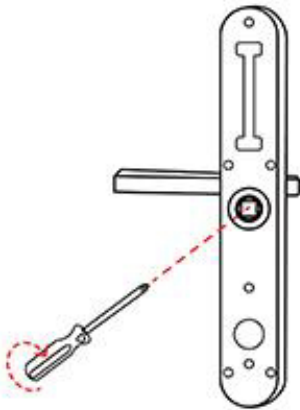

1. From the back face of the lock, loosen the inner hexagon screw of the handle in a clockwise direction.

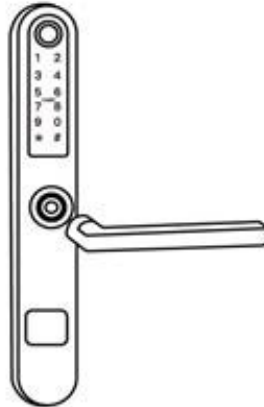

2. Remove the handle

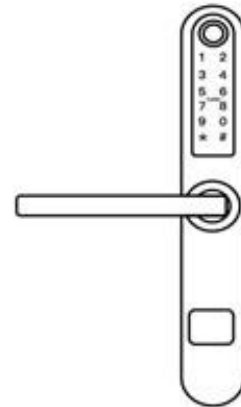

3. After adjusting the direction of the handle, insert it into the handle seat and re-lock the hexagon screw of the handle to complete the turning.

Inside handle:

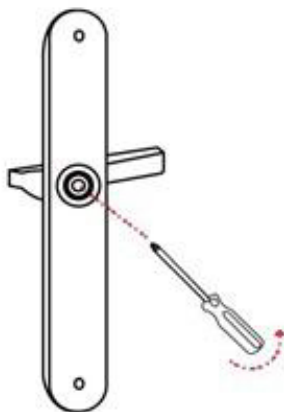

1. Turn the handle on the back panel, Loosen the inner hexagon screw of the handle counterclockwise



2. Remove the handle

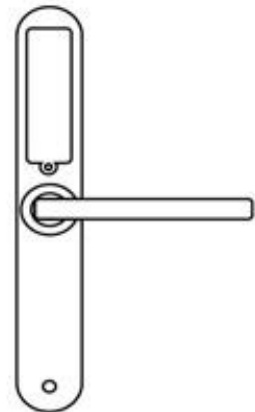

3. After adjusting the direction of the handle, insert it into the handle seat and re-lock the hexagon screw of the handle to complete the turning.

2.2. Installation Diagram

Step 1: Install Mortice

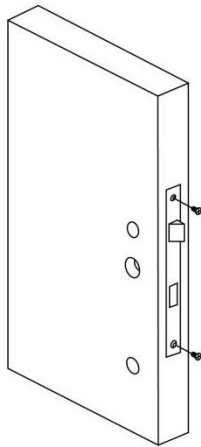

Using drilling template provided.

Step 2: Install Spindle

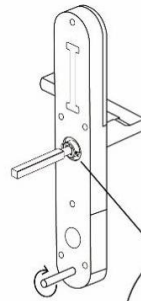

IMPORTANT:

If the handle points to the left, Turn the triangle point to left.

If the handle points to the right, Turn the triangle point to right.

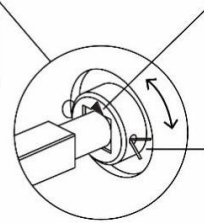

Insert the split pin into the hole and bend it's front end to fix to the square shaft.

Step 3: Install Sliding Screw Casing

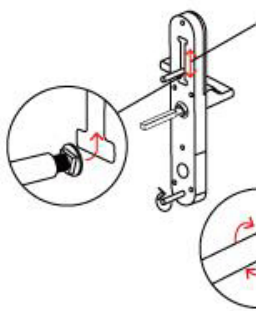

Adjust upper through bolt fixing from 55-100mm from spindle by sliding the screw casing far from the square shaft. Depending on the location of the hole-drilling or the old door hole..

Slot T-Screw in back face of lock. When in correct position, tighten depending on hole position in door.



Step 4: Connect Front and Back Panel Wires

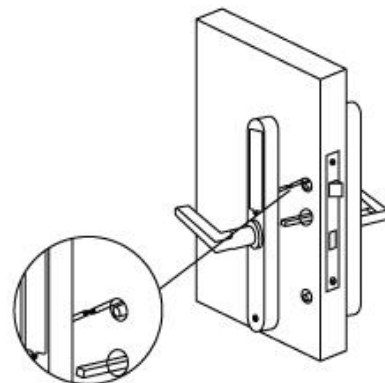

Step 5: Install Back Panel

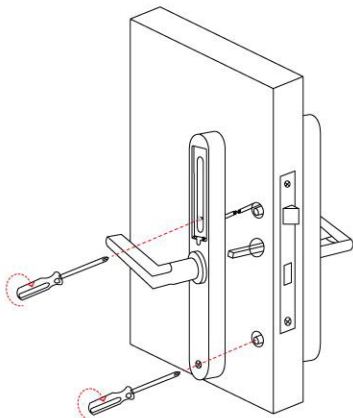

Step 6: Install Batteries

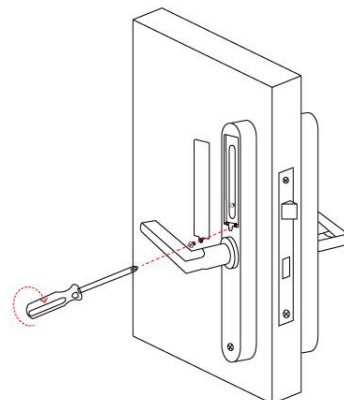

3. Operation

3.1.Registration

The appLOK app can be downloaded from the app store, and the Android version can be downloaded from the application store of Google play or scan the QR code below.



3.2.Connect lock to Device

1. Please scan the QR code to download the app
2. You can also search for appLOK in the APP store (Google Play) to download
3. Register a new account (phone number or email) or login with an existing account.
4. Touch the lock screen to light, click “+ Add Lock” 6) The lock nearby will appear on the phone screen, Click “+”
5. Re-name the lock
6. The lock added successfully

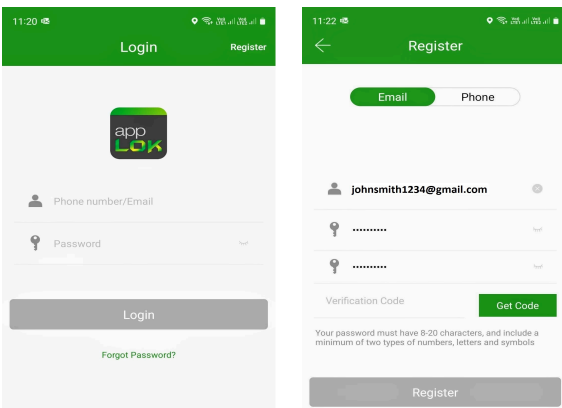

appLOK users can register the account by mobile phone and Email which currently support 200 countries and regions in the world. The verification code will be sent to user’s mobile phone or email, and the registration will be successful after the verification.

3.3.Add Locks

appLOK supports multiple types of lock devices. The lock needs to be added by the app after entering the add mode. Generally, a lock that has not been added, as long as the lock keyboard is touched, it will enter the add mode. The default password is 123456 if not added by the phone

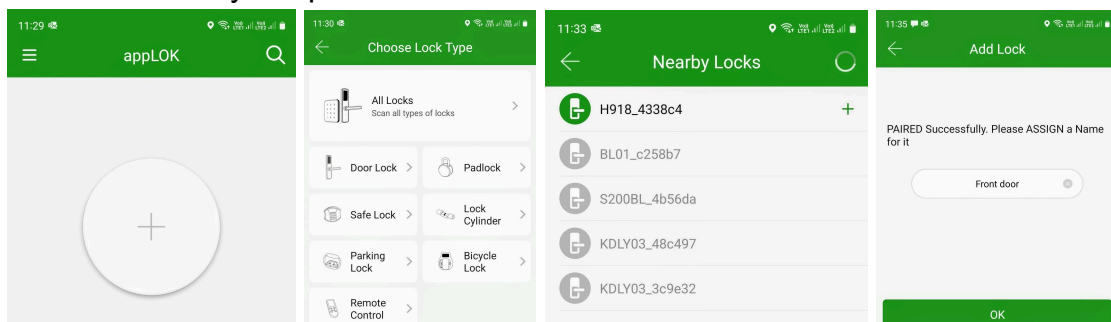

3.4 User Management

3.4.1 Bluetooth Management

Make sure there is no problem with Bluetooth communication. After connecting the phone to the door lock as above, Click “🔒” to unlock. (the phone is within 5meters from the door lock)

3.4.2 Setting Passcode

Passcodes are also a way to unlock. After entering the passcode on the locked keyboard, press the unlock button in the lower right corner to unlock. Passcodes are divided into permanent, time-limited, single, clear, cycle, and custom.(You can share the Passcode to other user via WeChat, SMS, Email, Messenger, WhatsApp)

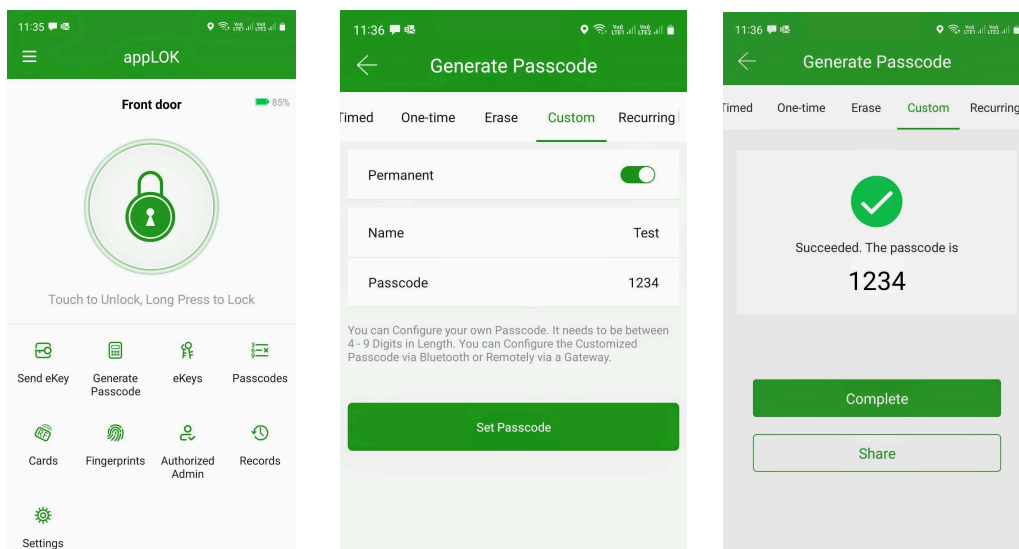

3.4.3 Send E-Key

Click on the “🔑” as shown in figure, you can send the eKey to other users of TTlock to authorize the unlock(the receiver must be download the APP and set up an account, Select e-key format (Timed, permanent, One-time, Recurring). Enter recipient’s account of TTlock,set the name and effective time of the eKey, Can choose to allow remote unlocking or disallowing, authorized administrator or not authorized, as shown in figure “Send” The recipient’s account has Bluetooth unlock permission

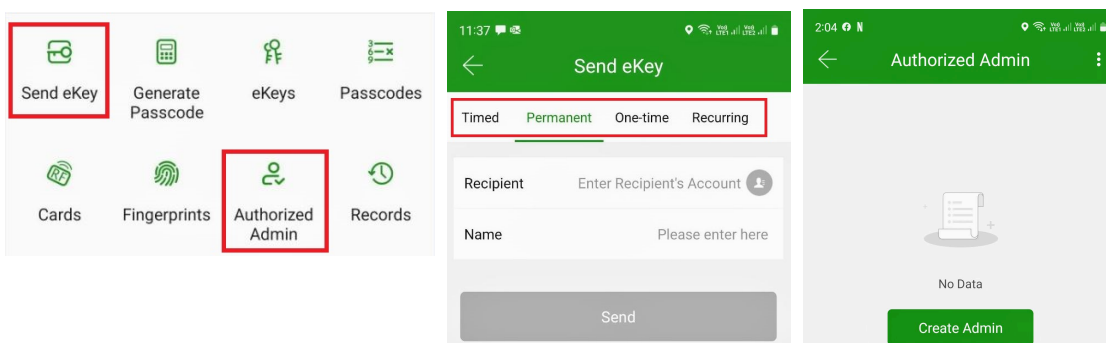

3.4.4 Add Card

Supports opening doors through various IC cards. Before an IC card is used to open the door, it needs to be added first. The adding process needs to be performed by the app beside the lock. The validity period of the IC can be set, it can be permanent, or it can be limited in time.

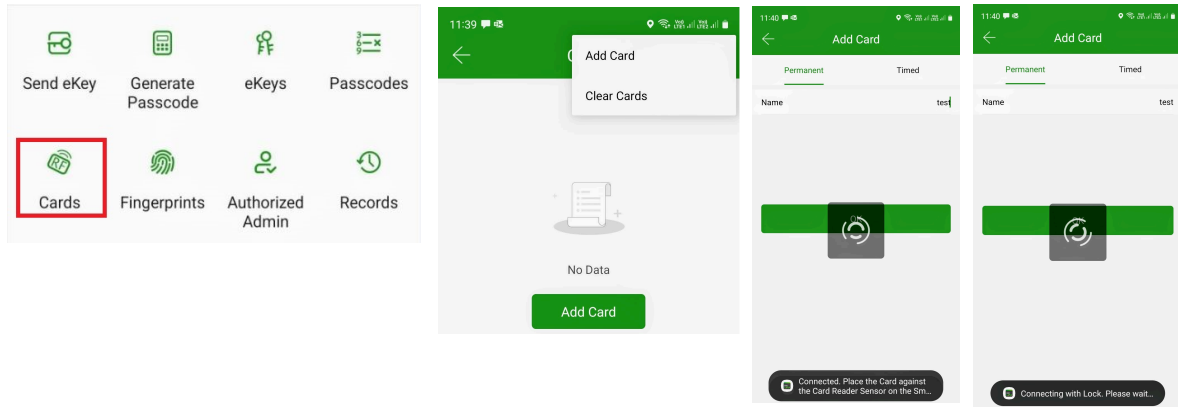

3.4.5 Add fingerprint

The function that a fingerprint can be used to open a door is that it needs to be added first. The adding process needs to be performed by the APP beside the lock. The fingerprint expiration data can be set, it can be permanent, or it can be limited. After setting, you can modify its validity period.

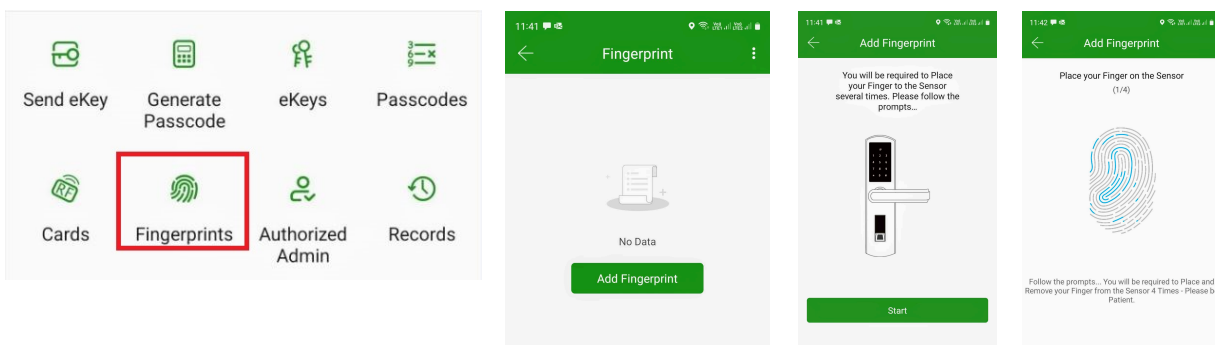

3.4.6 e-Key management

Click “eKeys” The manager can delete ekey, reset ekey, send and adjust the ekey, meanwhile he can search the lock record.

3.4.7 Passcode Management

Click “Passcodes”. All generated passwords can be viewed and managed in the password management module. This includes a password change, password deletion, password reset, and password unlock record.

3.4.8 Unlock Records

Click “Records” you can query your unlock record as shown in figure.

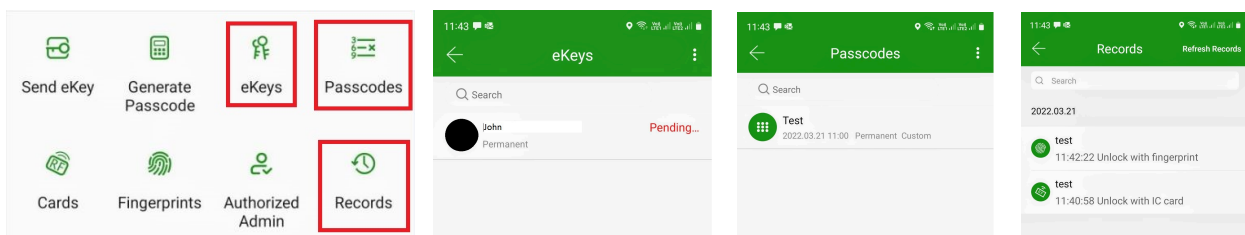

3.5 Gateway Management (optional)

The appLOK is directly connected via Bluetooth, so is not able to be hacked. The gateway is a bridge between smart locks and home WIFI networks. Through the gateway, the user can remotely view and calibrate the lock clock, read the unlock record. Meanwhile, it can remotely delete and modify the password.

3.5.1 Add Gateway

Light Status



When the gateway is powered on:

- • Light flashes alternately in red and blue: Stand-by mode, ready for pairing
- Blue light: Working mode
- Red light: Network failure

Pair the Gateway with APP

1 Activate the APP

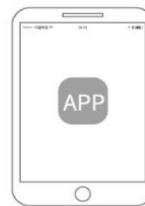

2 Press "☰"

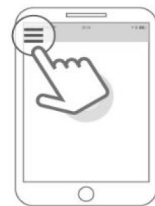

3 Select [Gateway]



4 Select [G2]

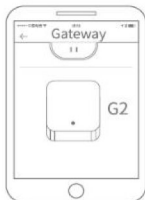

5 Plug in the gateway and power it on, while the light flashes alternately in red and blue

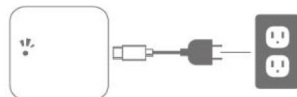

7 Add Gateway



8 Select the network and fill in the password



6 Press "+" sign



9 Add complete

⚠ Notice: If times out, please power off and try it again.

3.5.2 Manual

After a short period of time, you can see which locks are in their coverage in the app. Once the lock is bound to the gateway, the lock can be managed through the gateway.



APP User Instructions

4. Accessing your data via "Desktop Login"

You can access your locks via a Windows™ login and complete most tasks that the app can complete. By adding a Gateway hub then you can also open locks via the desktop login.

<http://applok.loktouch.com/>

Navigate to the "Desktop Login" shown above. Insert your current app login and password to enter the database.



Username

Password

Login

5. FAQ

<p>1) How to read operation records?</p>	<p>In the Records of the main interface. .</p>
<p>2) Why can't I unlock it after open the passage mode</p>	<p>You need to perform an unlock verification in any method, than the passage mode will take effect.</p>
<p>3) What is the purpose of Auto Lock</p>	<p>You can set how long to lock after unlocking</p>
<p>4) After installation, touch sensing keyboard, screen no respond</p>	<p>a) In this case, first check that the positive and negative electrodes of the battery have been installed upside down, whether the battery has enough power</p> <p>b) Remove the back panel and see if it's connected.</p> <p>c) To eliminate the above situation, you need to remove the lock ,check whether the wires of the lock body are squeezed, and the re-wire.</p>
<p>5) Unable to register fingerprint</p>	<p>Check fingers for dirt or wear, check the fingerprint head on the lock for dirt and oil stains, etc.</p> <p>Check to see if the fingerprint is working properly (Press to see if there is any responds.</p>
<p>6) What is the reason why the smart lock consumes fast power?</p>	<p>a) Large standby power consumption</p> <p>b) Short circuit</p>
<p>7) There is no response to pressing the handle on outside the door, and there is unlock normally on inside the door, but the verification is normal, and the motor is normal.</p>	<p>It may be the triangle direction on the clutch, please check fixing was positioned correctly as per fitting instructions.</p>
<p>8) How many times will the passcode be locked? How long is it locked?</p>	<p>Enter the wrong password more than 5 times in a row, the keyboard is locked for 5 mins, Other ways to can open the door</p>

PRODUCT WARRANTY

Customer Name: _____

Customer Phone: _____

Purchase Date: _____

Store Name: _____

Receipt #: _____

Product Name: _____

Product Model: _____

Note:

1. Please keep this card so that you can use it when you need warranty service.
2. We provide you with a two-year warranty from the date of purchase.



28 Glover Street
Ngauranga
Wellington 6035
Ph: +64 4 473 3025
Email: sales@levco.co.nz
Web: www.levco.co.nz